



TARGET  
TECHNOLOGY



INSTRUCTION MANUAL

# ALERT RECEIVER PLUS

RE-4K-PLUS-ANZ

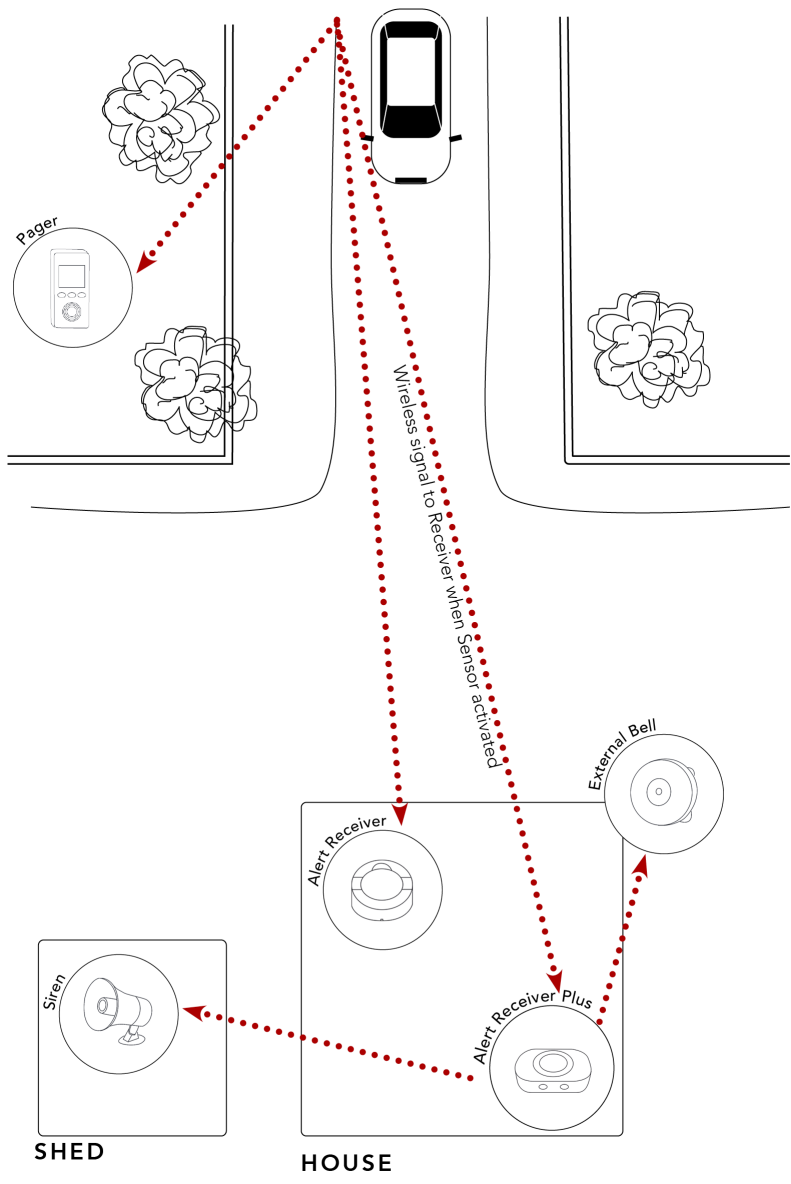

# ABOUT.

## HOW IT WORKS

The Alert Receiver Plus connects to our Alert Sensors.

When the connected Sensors are interrupted or activated, the Sensor sends a signal to the Alert Receiver Plus which plays a tone to alert you – so is usually set up in your house, shed, office etc.

There is a range of up to 1.6 km from the Sensors to the Alert Receiver Plus.

The Alert Receiver Plus allows for the connection of two accessories which will allow you to hear the alerts at other points on your property.

**The Alert Receiver Plus will receive signals from all of our Alert Sensors.**

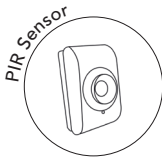

Detects heat motion in front of the Sensor.



Detects motion that passes between Beam Sensors.

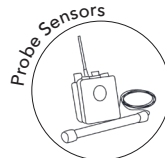

Detects metallic motion that passes near Sensor.

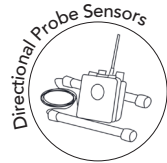

Detects direction of metallic motion that passes near Sensor.

# HELP.

## HAVING TROUBLE?

If you're having trouble with the installation of your kit, or have questions on how best to configure your kit, check out the Frequently Asked Questions on our website.

[www.bealert.co.nz/FAQ](http://www.bealert.co.nz/FAQ)

## POWERING YOUR RECEIVER

Connect the power adapter to the Alert Receiver Plus and then into a power outlet.

## SENSORS TO RECEIVER

If you are connecting Accessories to your Receiver, follow instructions on page 6-7 before configuring the Sensors to your Receiver.

### Configuring your Sensor to your Receiver

1. On the Receiver, press and hold the **MODE** button for 3 seconds until the lights on top of the Receiver flash.
2. There are 16 tunes to select from. Press the **VOLUME** button until you have selected your preferred tune.
3. Once you have found your preferred tune, activate your Alert Sensor:
  - **PIR:** wave your hand in front of the Sensor which will configure the two devices. A small beep will sound to confirm the configuration.
  - **Solar Beams:** Sensor A - press and release the **POWER** button. This will send a signal to your Receiver for connection. A short beep will sound on the Receiver to confirm the configuration.
  - **Probe:** pass a metal object (such as a hammer or key) by the probe, or manually move the probe a few inches. The receiver emits a short beep.
  - **Directional Probe:**
    - **Vehicles Entering:** Activate the wireless probe transmitter by pressing the "A" button on the transmitter board. You should hear a short beep from the receiver.
    - **Vehicles Leaving:** Activate the wireless probe transmitter by pressing the "B" button on the transmitter board. You should hear a short beep from the receiver.

# RESET. INSTALL.

4. Once configured, press and hold the **MODE** button until the lights on the Receiver stop flashing.
5. To test the Kit, activate the Sensor which should sound on your Receiver.

## Configuring more than one Sensor to Receiver

Repeat the process above, selecting a different tune for each Sensor to help you differentiate which Sensor has been activated.

## INSTALLING SENSORS

Once you have configured your Receiver to your Alert Sensors your Alert Sensors can be installed at your select entry point (ie driveway, fence line etc).

Instructions on how to install these sensors will be with your Sensor Kit, or are available on our website.

## DISCONNECTING RECEIVERS

### Removing Sensor Connections

- You can reset your Receiver to remove all the Sensors that are connected to it.
- Press and hold the **MODE** button until the lights flash.
- Press and hold the **MODE** and **SOUND** buttons together for five seconds. The lights will flash quickly then turn off. The Receiver has now disconnected all Sensors configured to it.
- To reconfigure Sensors, see page 4.

## CONFIGURING THE SETTINGS

Before you commence the programming of your Sensor to Receiver follow these instructions.

On the back of the Receiver, you need to set the DIP switches to control the actions when a signal is received. The back of your Receiver Plus looks like this:

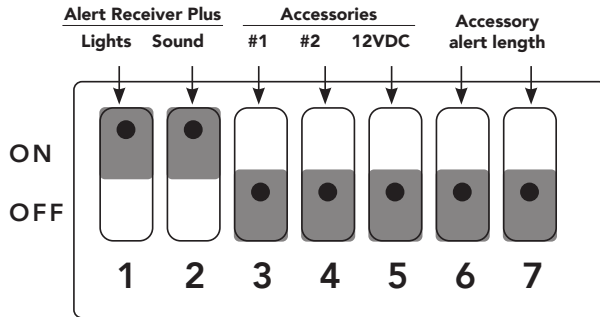

- **Dip 1 and 2:** Alert Receiver Plus notification settings when your Sensors are activated. We suggest you leave these alone.
- **Dip 3, 4, 5:** these are the settings for your connected accessories. Turn 3, 4 and 5 to ON, by sliding up.
- **Dip 6 and 7:** Accessories' settings that determine the length of time the alert will play for, for the accessories connected to 3, 4 or 5.

### Adjusting the Settings

1. On the Dip Panel, turn on 3, 4 and 5.
2. Now select the length of time that you would like the alert to play on your accessories.
  - **1 Second:** 6 is off, 7 is off.
  - **5 Seconds:** 6 is on, 7 is off.
  - **15 Seconds:** 6 is off, 7 is on.
  - **5 minutes:** 6 is on, 7 is on.

## CONNECTING ACCESSORIES

- The terminals work with low voltage wiring only.
- The Alert Receiver Plus has two relay outputs (NO, COM, NC) and a 12 VDC (+ and -) output terminal.

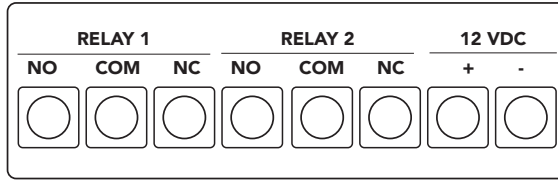

### Determining which Terminal to connect to

If you have purchased the Extension Whistle, Siren or Bell from us, these will be connected to the 12VDC terminals.

**Other Accessories:** if you are connecting accessories you have purchased elsewhere, we suggest you speak with an electrician who will be able to determine which terminal to connect to, or contact us and we may be able to help.

### Connecting to your Alert Receiver Plus

1. To connect lead wires to the terminals, strip off 10 mm of insulation from the end of the wire.
2. With a small screwdriver, press the orange button to open the terminal.
3. Insert the bare end of the wire into the terminal opening, then release the orange button. The terminal clamps down on the wire.
4. Pull gently on the wire to make sure that your connection is secure.
5. Now see pages 4-5 to connect your Sensors to the Receiver.
6. Test your accessory by activating the Sensor that is connected to your Alert Receiver Plus - your accessory should now activate.



# TARGET

TECHNOLOGY

## **NEW ZEALAND**

[www.bealert.co.nz](http://www.bealert.co.nz) | 0508 242 333

## **AUSTRALIA**

[www.bealert.com.au](http://www.bealert.com.au) | 1300 588 195

[info@bealert.co.nz](mailto:info@bealert.co.nz)