



TARGET
TECHNOLOGY



INSTRUCTION MANUAL

ALERT RECEIVER

DCR-4000-ANZ

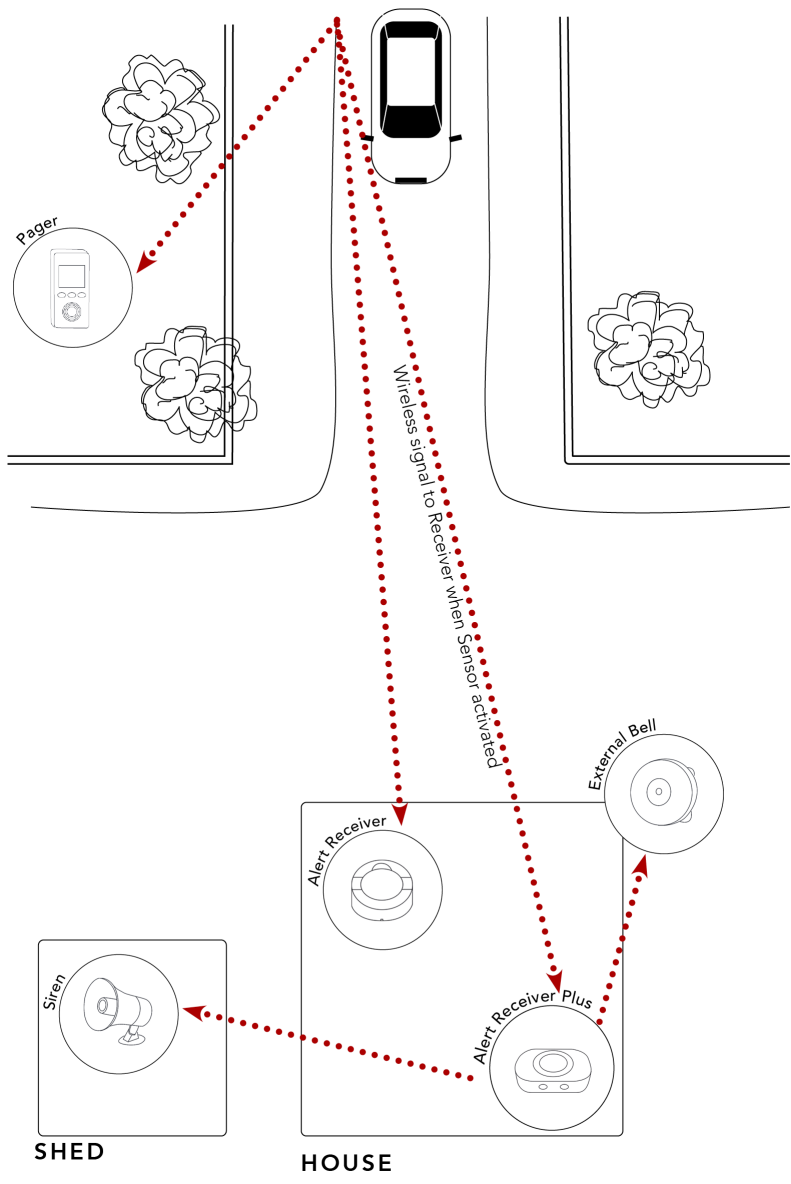

ABOUT.

HOW IT WORKS

The Alert Receiver connects to our Alert Sensors.

When the connected Sensors are interrupted or activated, the Sensor sends a signal to the Alert Receiver which plays a tone to alert you – so is usually set up in your house, shed, office etc.

There is a range of up to 1.6 km from the Sensors to the Alert Receiver.

The Alert Receiver will receive signals from all of our Alert Sensors.

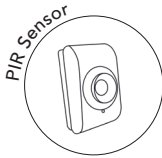

Detects heat motion in front of the Sensor.



Detects motion that passes between Beam Sensors.

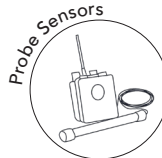

Detects metallic motion that passes near Sensor.

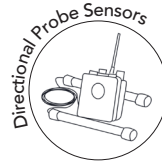

Detects direction of metallic motion that passes near Sensor.

HELP.

HAVING TROUBLE?

If you're having trouble with the installation of your kit, or have questions on how best to configure your kit, check out the Frequently Asked Questions on our website.

www.bealert.co.nz/FAQ

POWERING YOUR RECEIVER

Connect the power adapter to the Alert Receiver and then into a power outlet.

SENSORS TO RECEIVER

Configuring your Sensor to your Receiver

1. On the Receiver, press and hold the **MODE** button for 3 seconds until the lights on top of the Receiver flash.
2. There are 16 tunes to select from. Press the **VOLUME** button until you have selected your preferred tune.
3. Once you have found your preferred tune, activate your Alert Sensor:
 - **PIR:** wave your hand in front of the Sensor which will configure the two devices. A small beep will sound to confirm the configuration.
 - **Solar Beams:** Sensor A - press and release the **POWER** button. This will send a signal to your Receiver for connection. A short beep will sound on the Receiver to confirm the configuration.
 - **Probe:** pass a metal object (such as a hammer or key) by the probe, or manually move the probe a few inches. The receiver emits a short beep.
 - **Directional Probe:**
 - **Vehicles Entering:** Activate the wireless probe transmitter by pressing the "A" button on the transmitter board. You should hear a short beep from the receiver.
 - **Vehicles Leaving:** Activate the wireless probe transmitter by pressing the "B" button on the transmitter board. You should hear a short beep from the receiver.

INSTALLATION.

4. Once configured, press and hold the **MODE** button until the lights on the Receiver stop flashing.
5. To test the Kit, activate the Sensor which should sound on your Receiver.

Configuring more than one Sensor to Receiver

Repeat the process above, selecting a different tune for each Sensor to help you differentiate which Sensor has been activated.

INSTALLING SENSORS

Once you have configured your Receiver to your Alert Sensors your Alert Sensors can be installed at your select entry point (ie driveway, fence line etc).

Instructions on how to install these sensors will be with your Sensor Kit, or are available on our website.

DISCONNECTING SENSORS

Removing Sensor Connections

- You can reset your Receiver to remove all the Sensors that are connected to it.
- Press and hold the **Mode** button until the lights flash.
- Press and hold the **Mode** and **Sound** buttons together for five seconds. The lights will flash quickly then turn off. The Receiver has now disconnected all Sensors configured to it.
- To reconfigure Sensors, see page 4.

CONNECTING ACCESSORIES

If you would like to connect additional accessories such as Sirens or Lights to your kit, you will need to purchase the Alert Receiver Plus.

ACCESSORIES

Our products are designed with flexibility and our systems can all be customised for your situation.

Sensors

A variety of Sensors can be connected to your set up, and each Sensor differentiated with a different alert sound.

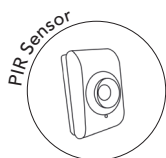

Detects heat motion in front of the Sensor.

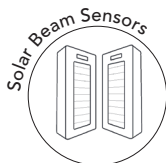

Detects motion that passes between Beam Sensors.

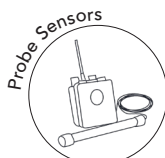

Detects metallic motion that passes near Sensor.

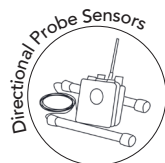

Detects direction of metallic motion that passes near Sensor.

Receivers

You can have multiple Receivers connected to your Sensors so that you can be alerted at different points on your property or around your home.



Alerts when Sensor activated and sends signal to additional accessories.

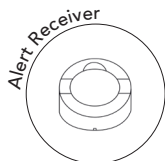

Alerts when Sensor activated.



Wireless Receiver that alerts when Sensor activated.

Additional Alerts / Volume

You can configure additional accessories for extra volume or alert points, such as outdoor lights, sirens or bells that can be connected to the Alert Receiver Plus.



TARGET

TECHNOLOGY

NEW ZEALAND

www.bealert.co.nz | 0508 242 333

AUSTRALIA

www.bealert.com.au | 1300 588 195

info@bealert.co.nz